

**FPA-SL30 – innovative and high-performance system:
FIXING FOR THIN LARGE SIZED CONCRETE FAÇADE ELEMENTS**

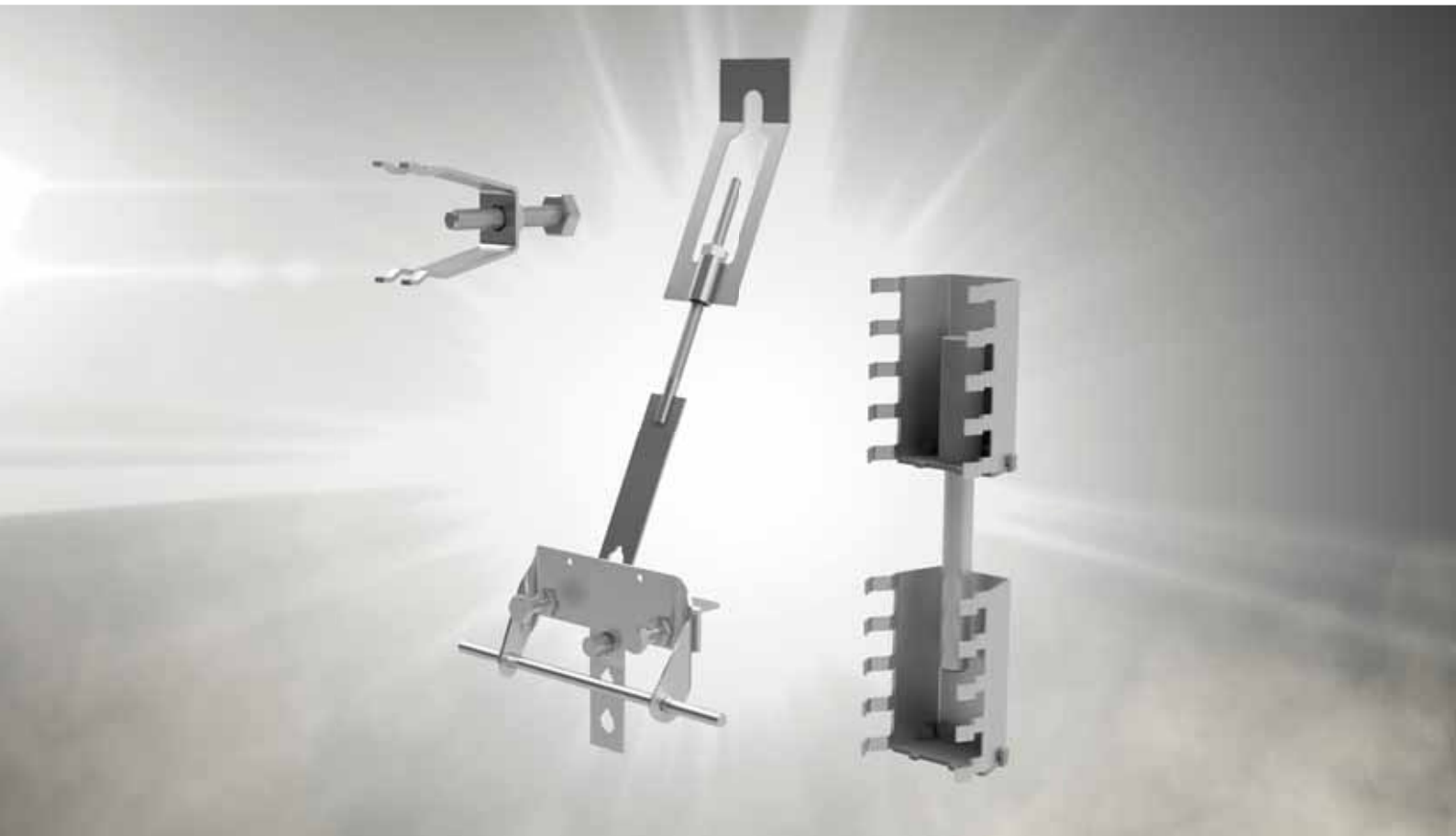

All features at a glance:



- › Complete system;
Building Authority Approved



- › Quick, simple
installation



- › Our Service team is available for
technical and on-site support

SHAPING THE FUTURE OF ARCHITECTURE

Textile-reinforced concrete façades – with the FPA-SL30!

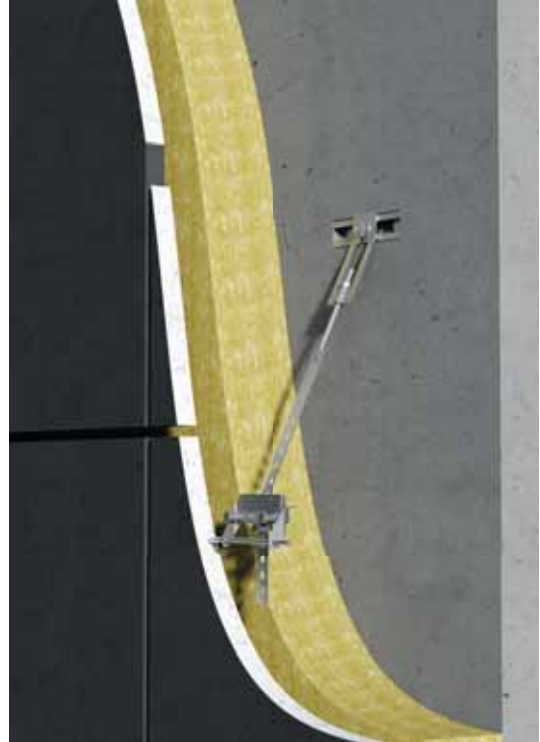

Project: maxmodul – Administration building TF2

Architects appreciate the modern look and the creative freedom that is possible with concrete curtain-wall façades. Now, thin, large-sized concrete façades with a thickness of only 30 mm can be securely fitted using the new HALFEN FPA-SL30 fixing system.

THIN, LIGHTWEIGHT, RESOURCE-FRIENDLY

Textile reinforcement (for example; from solidian) replaces the conventional concrete steel reinforcement in this type of thin, large-sized, concrete façade elements. This allows the panel thickness to be significantly reduced, which also reduces the amount of required concrete. Façade elements are significantly lighter and more versatile; this substantially lowers the cost for transport and installation.

Thicker insulation is also possible without reducing the usable floor space of the building. Usable floor space can even be increased if the insulation thickness remains the same.

NEW AREAS OF APPLICATION

Thin, large-sized, concrete façade elements create completely new possibilities for architects, engineers and precast manufacturers. In particular, because of the resulting lower loads that need to be transferred into the supporting structure, renovation of various types of façade systems is no longer a problem.

FPA-SL30 – THE IDEAL FIXING SOLUTION

Our products ensure that thin concrete façades remain fixed to the main structure. The innovative FPA-SL30 system makes use of the proven benefits of the FPA precast panel anchor system. Adjustability in all directions allows quick and easy installation of façade panels. A supporting substructure is not required. The official building authority approved precast panel anchors as well as the official building authority approved horizontal anchors are an economical and user-friendly system.

ANY FURTHER QUESTIONS?

Our technical support team will be happy to assist you with your planning.

Leviat

Please contact Leviat for more information on these products. Full contact details are available online at Leviat.com.

info@leviat.com

Imagine. Model. Make.

Leviat.com