

LIFTING ANCHOR SYSTEM HALFEN HD-SL30

Product Information

Textile reinforced concrete (TRC) has developed in recent years into a construction technique that has its benefits and advantages in applications where conventional types of reinforcement have their limits. It is possible to construct more slender and lightweight components, as the concrete covering to ensure corrosion resistance is no longer required. The corrosion resistance and the load-bearing capacity of carbon or glass fibre textile reinforcement are considerably higher than when using conventional reinforcement steel. This method allows thin, large-format façade panels with a thickness as low as 3 cm to be produced.

We developed the HD-SL30 Transport anchor system to ensure safe and reliable lifting and transport of this type of precast element; with thicknesses of ≥ 3.0 cm.

As with all our transport anchor systems, the HD-SL30 system meets the requirements of European Machinery Directive MD 2006/42/EC.



MD 2006/42/EC
EN 13155

To also guarantee safe application of the transport anchor system the resistances for the cast-in anchors are additionally subject to the requirements of the EN 13155.

**Important changes
for use in the UK:**



The UK is transitioning to its own UK based approval system and, as a result, from January 2023 will no longer accept CE marking. Leviat already has new UKCA marking in place and from 2023 at the latest, the UKCA mark will also be applied directly to the lifting systems, as required by the UKCA regulations. The conformity assessment processes and standards that can be used to demonstrate conformity under UKCA marking are aligned with those required for CE marking, so there is no difference in performance or testing requirements.

Anchor: HD-SL30

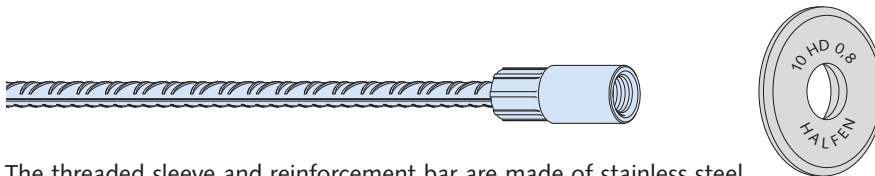

The threaded sleeve and reinforcement bar are made of stainless steel.

HD Anchor						
Load class	Article name	Article number	Thread diameter	External diameter	Length	Thread depth
			M	[mm]	[mm]	[mm]
0,8	6350-0,8-300 SL30 A4	0740.230-00001	10	14.1	300	7

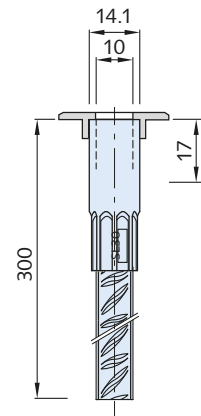

Identification cap

According to EN 13155 easy visual identification of the lifting anchor must be possible even after concreting.

The identification cap provides immediate visual reference, listing all pertinent anchor information, while its 30 mm radius also ensures the anchor centre is at least 15 mm from the bottom of the formwork. This ensures the relevant swivel-head lifting link can be used.

Identification cap				
Load class	Article name	Article number	Outer diameter [mm]	Colour
0,8	6357-10-SL30	0741.110-00011	30	dark grey

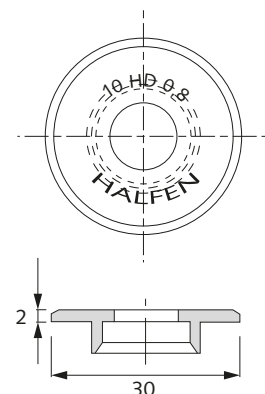

LIFTING ANCHOR SYSTEM HALFEN HD-SL30 FOR THIN, FIBRE REINFORCED ELEMENTS

Approved double-swivel lifting link

The lifting link has been developed for concrete elements with a minimal thickness of 30 mm. The head of the lifting link can be screwed into the anchor sleeve using a hex key.

Dimensions [mm]									
Thread	L1	S1	S2	A	B	D	E	F	G
M10	17	8	16	33	30	38	27	14	53

Lifting link		
Load class	Article name	Article number
0,8	6318-0,8 DSR	0742.250-00001
	6318-0,8 DSR-C	0742.250-00101
	6318-0,8 DSR-C+P	0742.250-01001
DSR-C = Double swivel lifting link, certified		
DSR-C+P = Double swivel lifting link, tested and certified		

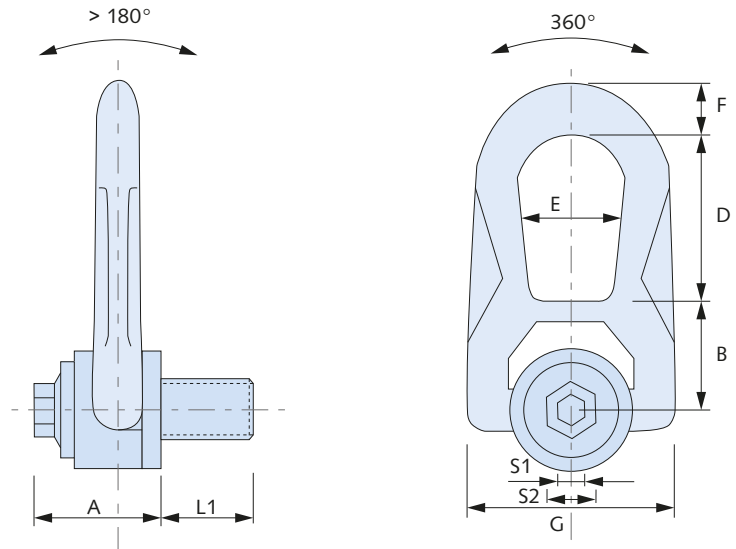

Required additional reinforcement

The glass fibre or carbon reinforcement in the middle of the panels may have to be cut out to allow for the anchors. If required, the relevant cross-section of reinforcement must be supplemented below and/or above the anchor. Two stainless steel reinforcement bars (2 $\phi 6 \times 500 - A4$) are required as additional reinforcement at each lifting anchor. One bar must be placed directly under and next to the threaded sleeve; the second is to be placed 15 cm lower.

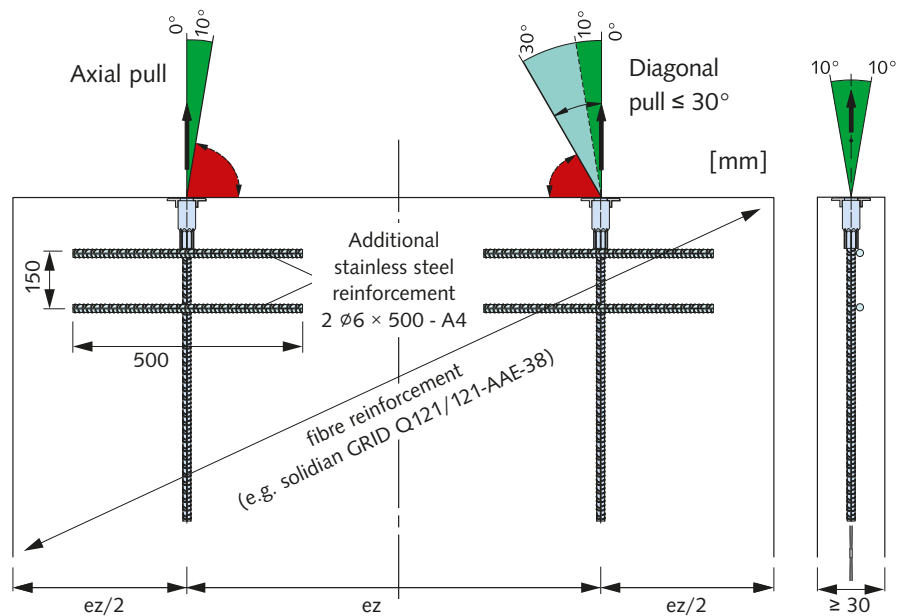

Load capacities for HD-SL30 Anchor with corresponding DSR Lifting link					
Load class	Article name	Minimum element thickness [mm]	Edge distance [mm] ez/2	Load capacity, concrete compressive strength $\geq 50 \text{ N/mm}^2$	
				Axial pull [kN]	Diagonal pull $\leq 30^\circ$
0,8	6350-0,8-300 SL30 A4	30	300	8.0	6.4

Leviat
Please contact Leviat for more information on these products.
Full contact details are available online at Leviat.com.

info@leviat.com

Imagine. Model. Make.

Leviat.com